

Kit12

For further information visit:
support.lampspares.co.uk
Search for IS12 in the search box.

Ref:
IS-12

Kit Contains:

1x Cable Cord Set	1x Cord Grip
1x BC Lampholder	1x Nut Cover
1x All Threaded Rod	2x Steel Nuts
1x Plastic Washer	1x Tube Cover
2x Steel Washers	
1x Tube Grommet	

Before you start please ensure you are competent to carry out electrical work and ensure the electricity is turned off.

If in any doubt stop what you're doing and seek professional advice.

A full step by step guide is available from support.lampspares.co.uk and searching IS12 in the search box.

Step 1: Install the threaded rod, nut and washers onto your lamp base as shown below.

Note the lampholder will need to be separated and only the base installed for now.

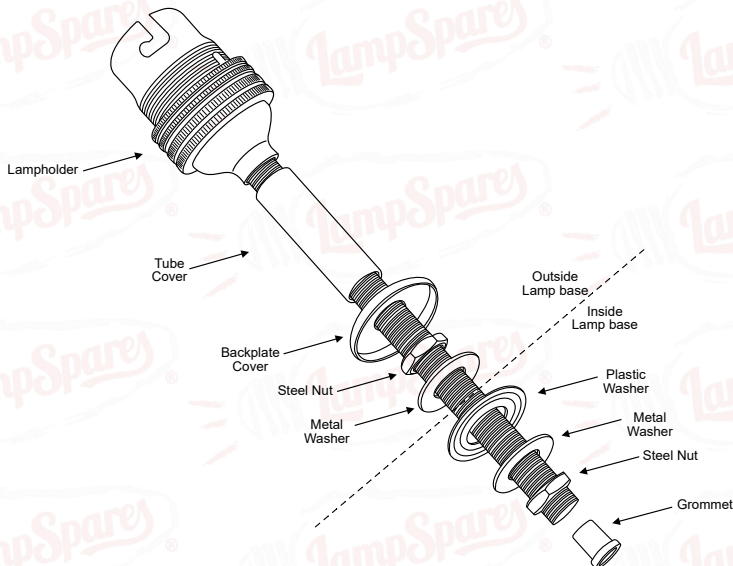

Step 2: Ensure the threaded rod is sticking out the top of the vase enough for the cover and lampholder to fit, below is a quick guide on the correct lengths.

- For the 38mm kit leave 50mm of thread sticking out the top of the lamp base.
- For the 75mm kit leave 87mm of thread sticking out the top of the lamp base.

Step 3: Push the cable through the hole and out the bottom of the vase. Then grab the cord grip and install it onto the cable as shown below, ensure that once the cable has been pushed through the top assembly the cord grip is sitting behind the entry hole.

This means if you pull on the cable it will not rip out of the lampholder.



Step 4: Wire the lampholder connection unit and carefully push the connection unit into the lampholder's base.

Step 5: Screw the top section of the lampholder onto the lampholder base ensuring the alignment is correct, as below.

The indents on all 3 parts must align.

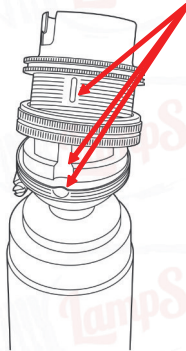

After installing, look down on the lampholder. The pins and notches should be as shown below.

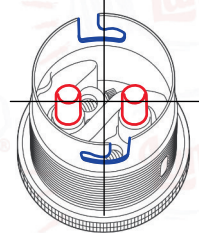

If you have any concerns or difficulties in connecting this product please contact us, details at the bottom of this guide.

All electrical parts confirm to BS standards and have full CE approval, please email for copies.

LIAQA
ASSURED
COMPANY



spares  **you**

Unit 3 Brookside Business Park | Brookside Avenue | Rustington | West Sussex | BN16 3LP

T: 01903 776644 | KB: support.lampspares.co.uk

© Lampspares. All Rights Reserved

Rev: 01-A - 27/06/2022